

## RM12-1.3

### Technical Specifications

|                          |                      |
|--------------------------|----------------------|
| Nominal Voltage          | 12V                  |
| Nominal Capacity         | 1.3AH(20HR)          |
| Dimension                |                      |
| Length                   | 3.82inches(97mm)     |
| Width                    | 1.69inches(43mm)     |
| Height                   | 2.05inches(52mm)     |
| Total Height /w Terminal | 2.28inches(58mm)     |
| Weight                   | Approx 1.3lb(0.59kg) |
| Standard terminal        | Type B               |

### Capacity Specifications

|                 |                   |        |
|-----------------|-------------------|--------|
| Cut Off Voltage | 20Hr Rate(0.065A) | 1.30AH |
| 1.75v/c@25°C    | 10Hr Rate(0.12A)  | 1.20AH |
| 1.75v/c         | 5Hr Rate(0.21A)   | 1.05AH |
| 1.67v/c         | 1Hr Rate(0.78A)   | 0.78AH |
| 1.67v/c         | 15Min Rate(2.6A)  | 0.65AH |

### Charging Specifications

|   |               |           |
|---|---------------|-----------|
|   |               | Bloc      |
| Charge Voltage( <i>constant</i> )                 | Float         | 13.5~13.8 |
|   | Cycle         | 14.4~15.0 |
| Internal Resistance<br>(Fully Charged Battery)    | < 90mΩ        |           |
| Discharge Current Amps<br>(5 seconds maximum)     | 19            |           |
| Max.Charge Current                                | 0.39A         |           |
| Approx Final Charge<br>Current<br>(2.25v/c Float) | 0.003(3mA)    |           |
| Approx Final Charge<br>Current<br>(2.45v/c Float) | 0.01(10mA)    |           |
| Self Discharge                                    | 6 Months@25°C |           |

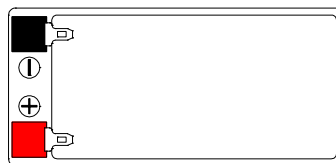

Unit:mm(±0.50)

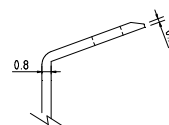
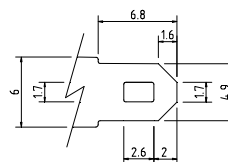
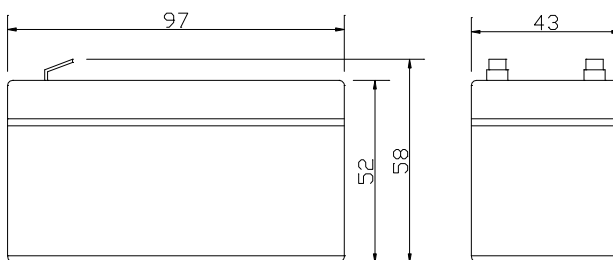

Type B Terminal



### Actual Wattage/Ampere Capacity at Various Discharge (Voltage @25°C)

| Cut Off Voltage | Time |      |       |       |       |       |       |  |
|-----------------|------|------|-------|-------|-------|-------|-------|--|
|                 |      | 5min | 10min | 15min | 30min | 45min | 60min |  |
| 9.6V            | W    | 62.4 | 40.6  | 31.2  | 17.9  | 13.2  | 10.1  |  |
| 9.9V            | W    | 60.4 | 39.8  | 30.6  | 17.8  | 13.2  | 10.0  |  |
| 10.2V           | W    | 57.8 | 38.8  | 29.9  | 17.5  | 12.9  | 9.9   |  |
| 10.5V           | W    | 54.4 | 37.5  | 29.0  | 17.1  | 12.7  | 9.7   |  |
| 10.8V           | W    | 47.0 | 34.6  | 27.7  | 16.5  | 12.0  | 9.5   |  |

#### Sales Office:

9/F, 30 Wong Chuk Hang Road, Aberdeen, Hong Kong

Tel: 2555-1394 ext163 Web: [www.remcobattery.com](http://www.remcobattery.com)

Fax: 2873-4229

Email: [sales@remcobattery.com](mailto:sales@remcobattery.com)

Rev. 100719