

## RM12-26

Unit:mm(±0.50)

### Technical Specifications

Nominal Voltage	12V
Nominal Capacity	26.0AH(20HR)
Dimension	
Length	6.87inch(174mm)
Width	6.50inch(165mm)
Height	4.92inch(125mm)
Total Height /w Terminal	4.92inch(125mm)
Weight	Approx 18.48lb(8.4kg)
Standard terminal	Type C/E

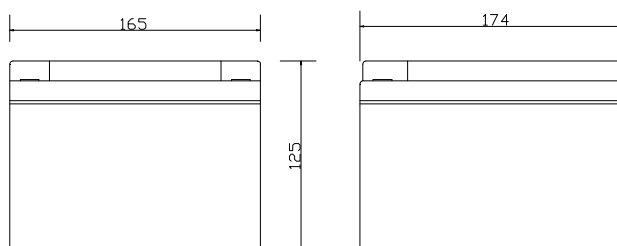
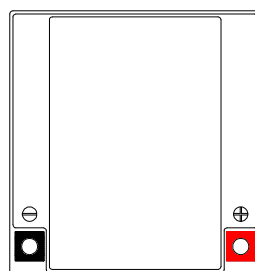

### Capacity Specifications

Cut Off Voltage	20Hr Rate(1.3A)	26.0AH
1.75v/c@25°C	10Hr Rate(2.39A)	23.9AH
1.75v/c	5Hr Rate(4.16A)	20.8AH
1.67v/c	1Hr Rate(15.6A)	15.6AH
1.67v/c	15Min Rate(42A)	13.0AH

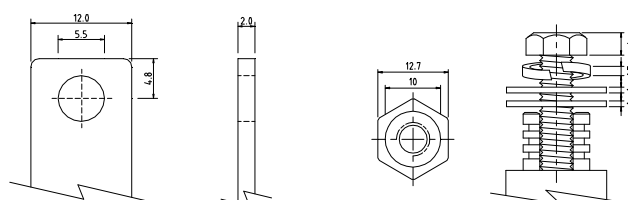

Type C Terminal  
Nut & Bolt

Type E Terminal  
Copper Inserted

### Charging Specifications

		Bloc
Charge Voltage( <i>constant</i> )	Float	13.5~13.8
	Cycle	14.4~15.0
Internal Resistance (Fully Charged Battery)	< 10mΩ	
Discharge Current Amps (5 seconds maximum)	260	
Max.Charge Current	7.8A	
Approx Final Charge Current (2.25v/c Float)	0.05(50mA)	
Approx Final Charge Current (2.45v/c Float)	0.25(250mA)	
Self Discharge	6 Months@25°C	



### Actual Wattage Capacity at Various Discharges (Voltage @25°C)

Cut Off Voltage	Time	Time						
		5min	10min	15min	30min	45min	60min	
9.6V	W	1248.0	811.2	624.0	358.8	264.7	202.8	
9.9V	W	1208.0	795.1	611.5	355.2	263.2	200.7	
10.2V	W	1156.0	776.9	598.0	350.5	258.3	198.1	
10.5V	W	1087.8	749.8	579.8	342.7	253.2	194.9	
10.8V	W	940.2	692.1	554.3	330.2	240.5	189.2	

#### Sales Office:

9/F, 30 Wong Chuk Hang Road, Aberdeen, Hong Kong

Tel: 2555-1394 ext163 Web: [www.remcobattery.com](http://www.remcobattery.com)

Fax: 2873-4229

Email: [sales@remcobattery.com](mailto:sales@remcobattery.com)