

RM12-7.2DC

Technical Specifications

Nominal Voltage	12V
Nominal Capacity	7.2AH(20HR)
Dimension	
Length	5.98inches(152mm)
Width	2.56inches(65mm)
Height	3.66inches(93mm)
Total Height /w Terminal	3.94inches(100mm)
Weight	Approx 4.84lb(2.20kg)
Standard terminal	Type A/G

Capacity Specifications

Cut Off Voltage	20Hr Rate(0.36A)	7.2AH
1.75v/c@25°C	10Hr Rate(0.66A)	6.6AH
1.75v/c	5Hr Rate(1.15A)	5.75AH
1.67v/c	1Hr Rate(4.32A)	4.32AH
1.67v/c	30Min Rate(7.92A)	3.96AH

Charging Specifications

		Bloc
Charge Voltage(<i>constant</i>)	Float	13.5~13.8
	Cycle	14.4~15.0
Internal Resistance (Fully Charged Battery)	< 26mΩ	
Discharge Current Amps (5 seconds maximum)	108	
Max.Charge Current	2.16A	
Approx Final Charge Current (2.25v/c Float)	0.014(14mA)	
Approx Final Charge Current (2.45v/c Float)	0.07(70mA)	
Self Discharge	6 Months@25°C	

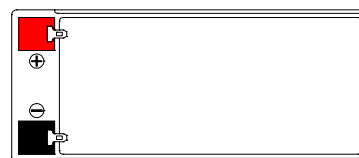

Unit:mm(±0.50)

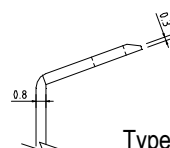
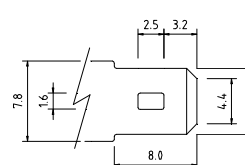
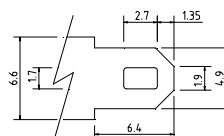
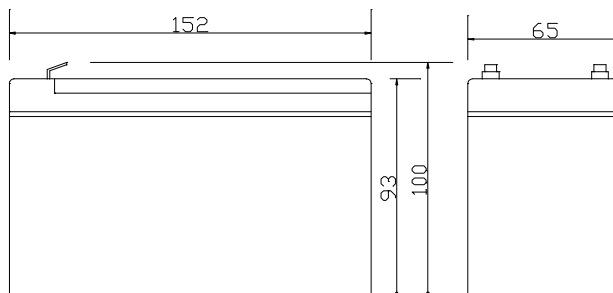

Type A Terminal

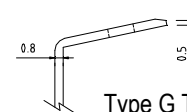

Type G Terminal
(Optional)



Actual Wattage Capacity at Various Discharges (Voltage @25°C)

Cut Off Voltage	Time	Time					
		5min	10min	15min	30min	45min	60min
9.6V	W	331.2	215.3	165.6	95.2	70.2	53.8
9.9V	W	320.6	211.0	162.3	94.3	69.9	53.3
10.2V	W	306.8	206.2	158.7	93.0	68.6	52.6
10.5V	W	288.7	199.0	153.9	90.9	67.2	51.7
10.8V	W	249.5	183.7	147.1	87.6	63.8	50.2

Sales Office:

9/F, 30 Wong Chuk Hang Road, Aberdeen, Hong Kong

Tel: 2555-1394 ext163 Web: www.remcobattery.com

Fax: 2873-4229

Email: sales@remcobattery.com

Rev. 100719