

RM12-7.5

Technical Specifications

Nominal Voltage	12V
Nominal Capacity	7.5AH(20HR)
Dimension	
Length	5.98inches(152mm)
Width	2.56inches(65mm)
Height	3.66inches(93mm)
Total Height /w Terminal	3.94inches(100mm)
Weight	Approx 5.17lb(2.35kg)
Standard terminal	Type A/G

Capacity Specifications

Cut Off Voltage	20Hr Rate(0.375A)	7.5AH
1.75v/c@25°C	10Hr Rate(0.69A)	6.9AH
1.75v/c	5Hr Rate(1.2A)	6.0AH
1.67v/c	1Hr Rate(4.5A)	4.5AH
1.67v/c	15Min Rate(15A)	3.75AH

Charging Specifications

		Bloc
Charge Voltage(<i>constant</i>)	Float	13.5~13.8
	Cycle	14.4~15.0
Internal Resistance (Fully Charged Battery)	< 26mΩ	
Discharge Current Amps (5 seconds maximum)	113	
Max.Charge Current	2.2A	
Approx Final Charge Current (2.25v/c Float)	0.015(15mA)	
Approx Final Charge Current (2.45v/c Float)	0.075(75mA)	
Self Discharge	6 Months@25°C	

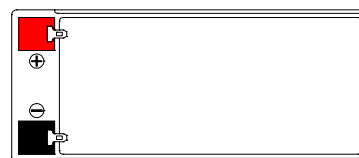

Unit:mm(±0.50)

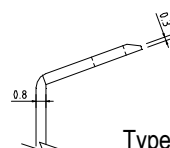
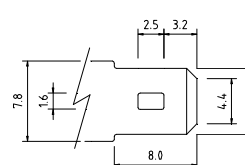
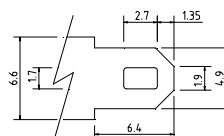
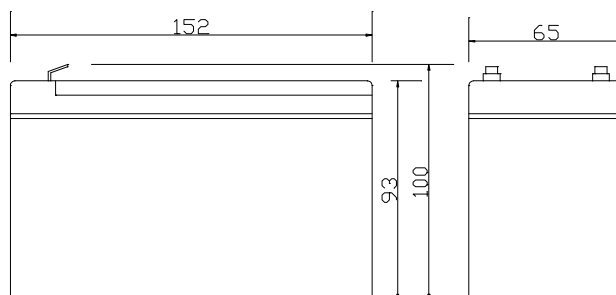

Type A Terminal

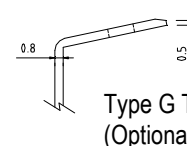

Type G Terminal
(Optional)



Actual Wattage Capacity at Various Discharges (Voltage @25°C)

Cut Off Voltage	Time	Time						
		5min	10min	15min	30min	45min	60min	
9.6V	W	360.0	234.0	180.0	103.5	76.4	58.5	
9.9V	W	348.5	229.4	176.4	102.5	75.9	57.9	
10.2V	W	333.5	224.1	172.5	101.1	74.5	57.2	
10.5V	W	313.8	216.3	167.3	98.9	73.1	56.2	
10.8V	W	271.2	199.7	159.9	95.3	69.4	54.6	

Sales Office:

9/F, 30 Wong Chuk Hang Road, Aberdeen, Hong Kong

Tel: 2555-1394 ext163 Web: www.remcobattery.com

Fax: 2873-4229

Email: sales@remcobattery.com

Rev. 100719